



Step-by-Step with Modern Masters

RECIPÉ N° 12 | Exterior Metallics for the Garden



Metallic Primers and Exterior Metallic Paint are an incredible duo to use for outdoor projects. They are water, mold, mildew, chemical, stain, mar, impact and UV resistant, so no additional protective top coat is required. It's perfect for light fixtures, patio furniture, walls, garden accents, and much more. For this project, we've taken an old fountain and transformed it into a beautiful garden planter.

PRODUCTS NEEDED

- Modern Masters Warm Metallic Paint Primer
- Modern Masters Cafe Bronze Exterior Metallic Paint
- Modern Masters Dome Gold Exterior Metallic Paint
- Acrylic Bonding Primer

TOOLS NEEDED

- 2" and 4" Chip Brushes
- 1" Blue Painters Tape
- Rags and Mixing Containers



Step-by-Step with Modern Masters

RECIPÉ N° 12 | Exterior Metallics for the Garden

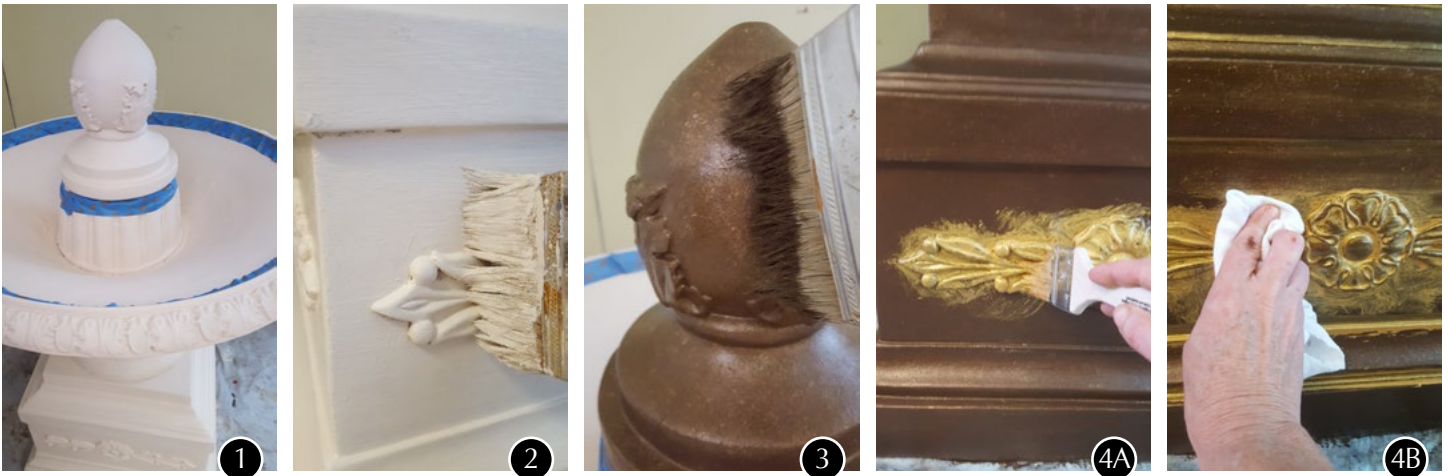

STEP 1: Clean fountain thoroughly before starting. Tape off any areas of the fountain that will be in contact with continuous moisture (i.e., the basin and bottom of finial). Primer the fountain with an acrylic bonding primer suitable for the surface material. Let dry.

STEP 2: Using the 4" chip brush apply the Warm Metal Primer to 100% of the surface. Let dry 2 - 3 hours.

STEP 3: Apply Cafe Bronze Exterior Metallic Paint to 100% of the surface using the 4" chip brush. Let dry for 1 hour. Repeat the process until no primer can be seen thru the paint. Be sure to let each layer dry approximately 1 hour between layers. Let the final layer dry overnight.

STEP 4: Focusing on the textured areas, use the 2 inch chip brush to paint Gold Dome Exterior Metallic Paint over the surface. Immediately wipe off the excess gold with a smooth damp rag allowing the gold to pool in the recesses. Work in small areas no larger than 2 foot square. Let dry 24 hours.

You are done!